



QSNCC

Exhibitors Briefing Presentation

Updated as of 18 July 2022

Subjects

- 1 Routing to QSNCC – entrance & exit gates**
- 2 Loading area – entrance & exit**
- 3 Parking Rules**
- 4 QSNCC Rules & Regulations**

Routing to QSNCC, Entrance & Exit Gates



Routing to QSNCC, Entrance & Exit Gates



BTS Skytrain "Asok" station
Then board MRT Subway for 1
station to "Queen Sirikit Center"



MRT Subway
Station : "Queen Sirikit Center"



Public Bus numbers # 136, 185, and 501
(Bus stop is located in front of QSNCC)



Routing to QSNCC, Entrance & Exit Gates

Main Gates

Gate# 1 = in & out from/for
Ratchadapisek Road

Gate# 2 = in & out from/for
Ratchadapisek Road

Gate# 3 = in & out from/for
Rama 4 Road

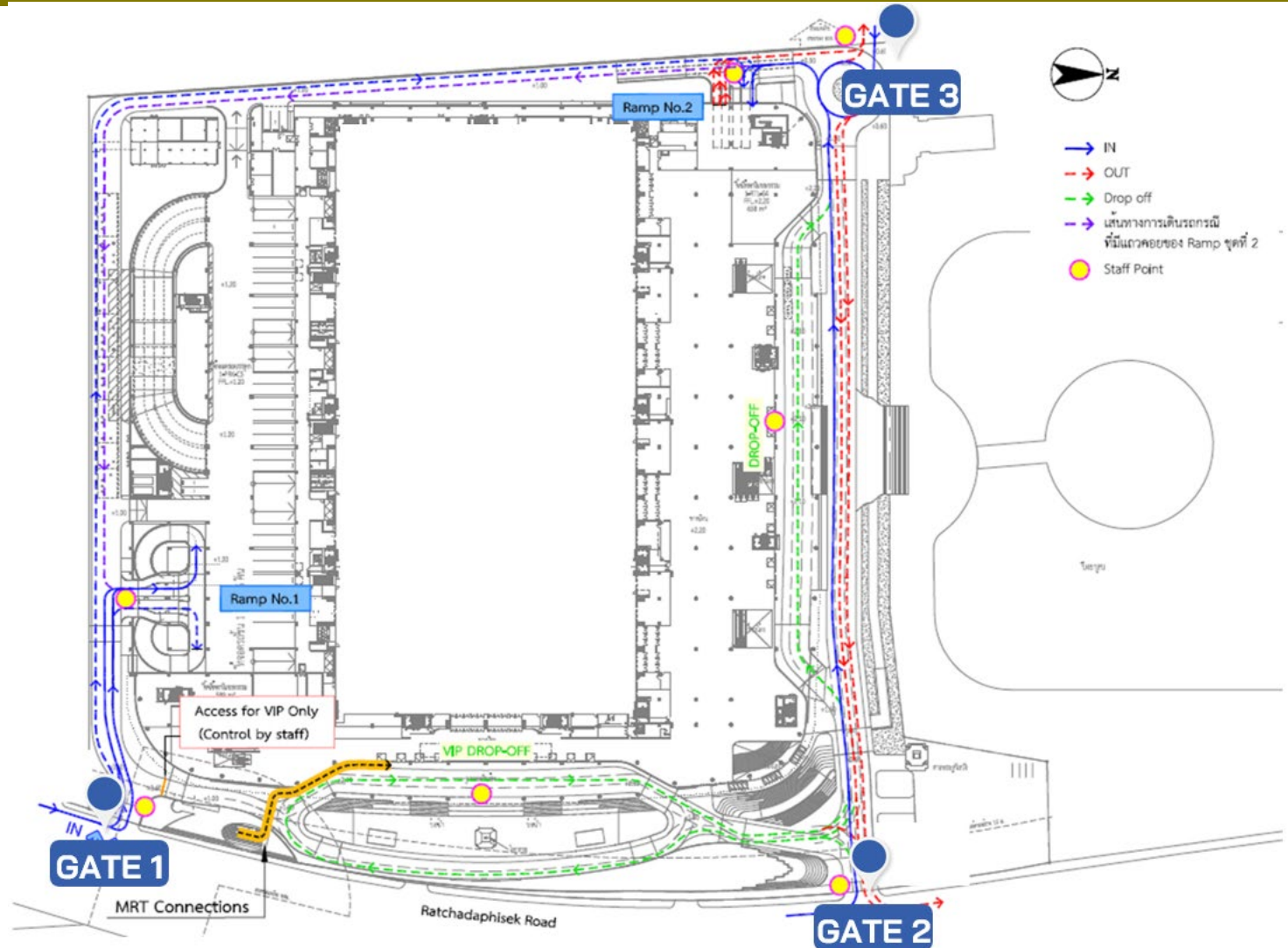

Entrances & Exits

Entrances & Exits

G Level

- Ratchadapisek Entrance
- Lakeside Entrances
- Atrium Entrance

LG Level

- MRT Subway Connection

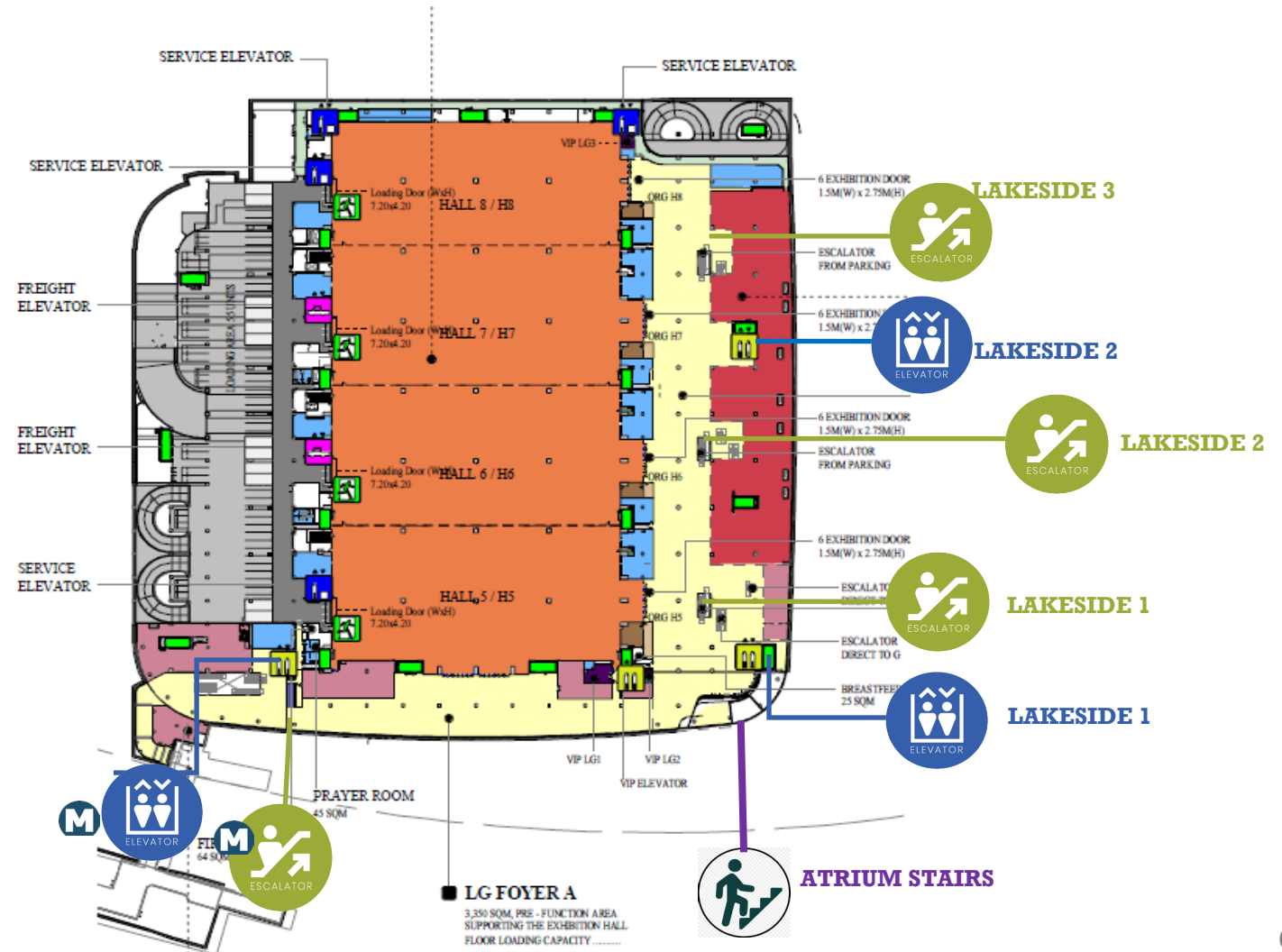

Entrance & Exits for Loading Area : G Level

Loading Entrance at G Level

Loading
Entrance

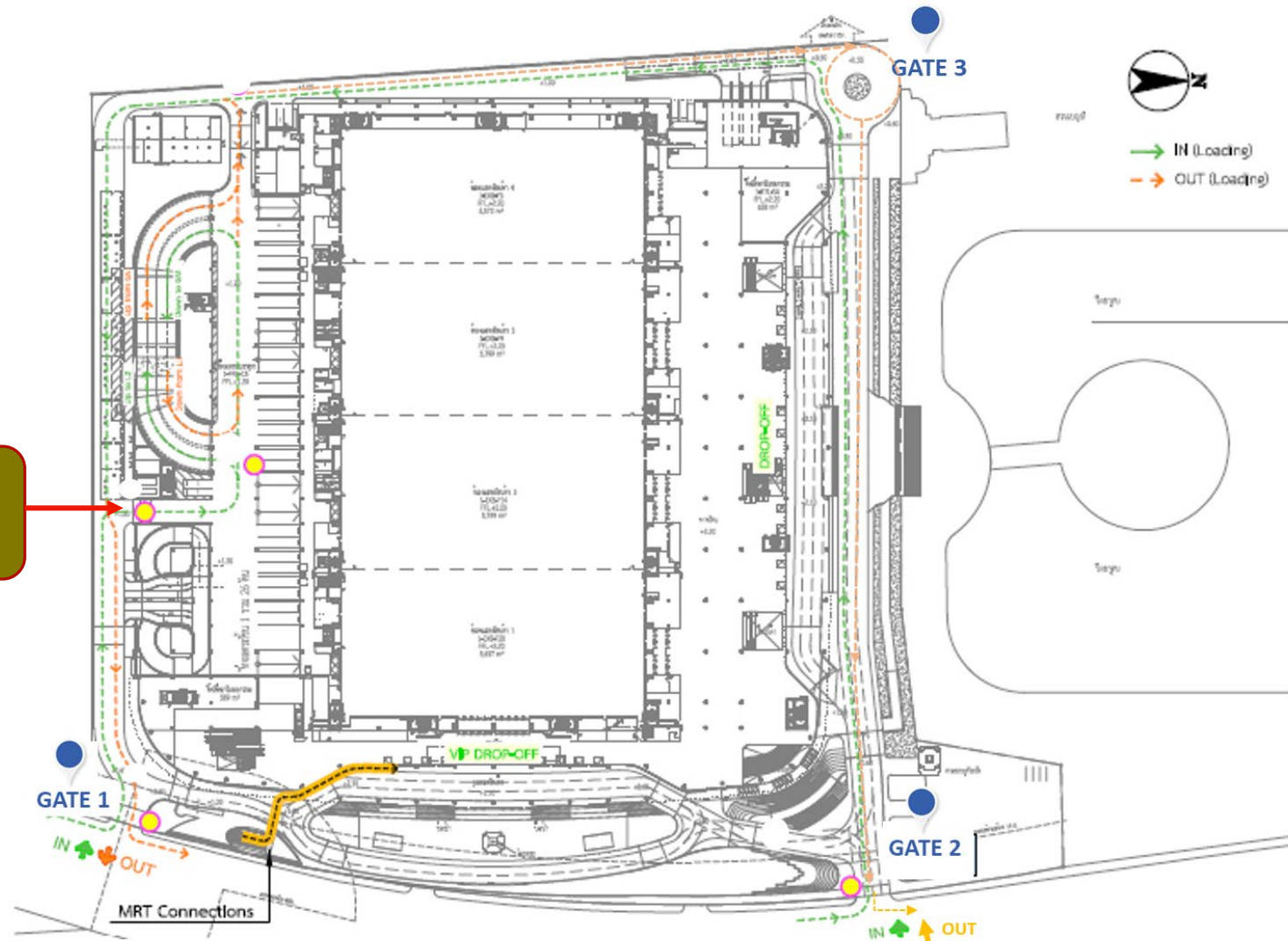

Entrance & Exits for Loading Area : Level 1

Level 1

Maximum Height = 5 Meters

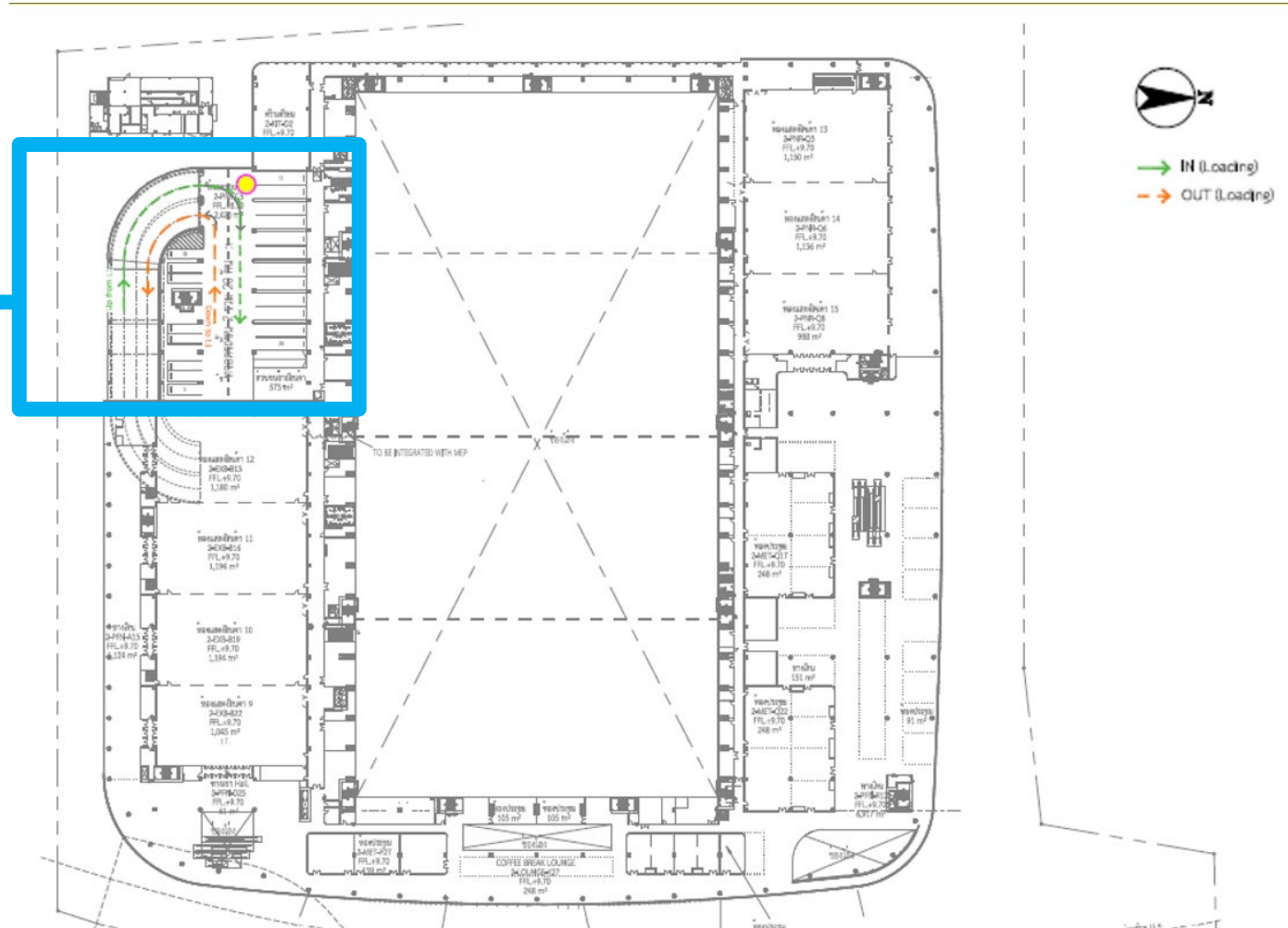
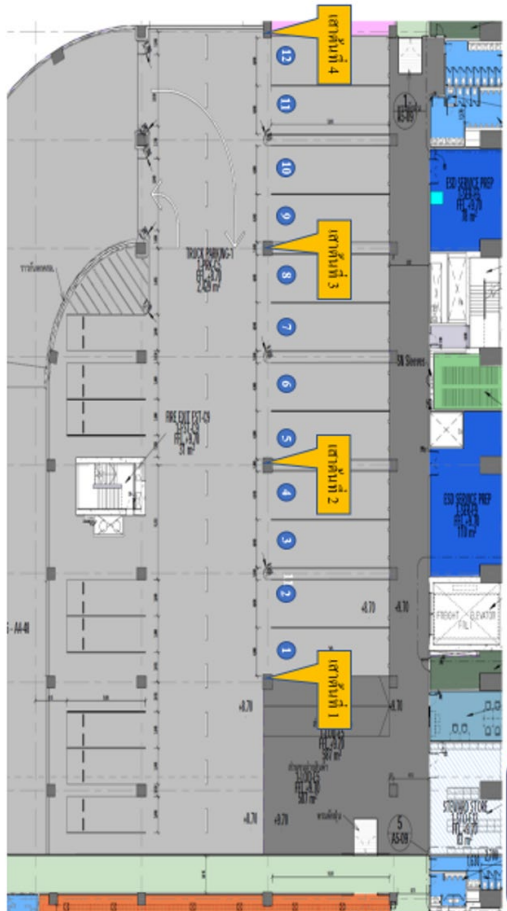

Parking Rules for Loading Vehicles

All loading vehicles to be parked at the Loading Area

Conditions for 4-wheel Vehicles

- Free parking for 45 minutes
- If over 45 minutes, penalty fee applied at THB 200 per hour
(A Fraction Of An Hour To Be Charged For One Full Hour)
- Lost or Damage of a parking card will be fined at THB 300



Conditions for 6-wheel Vehicles and above

- Free parking for 90 minutes
- If over 90 minutes, penalty fee applied at THB 200 per hour
(A Fraction Of An Hour To Be Charged For One Full Hour)
- Lost or Damage of a parking card will be fined at THB 300

Parking Rules for Normal Vehicles

Normal vehicles can be parked on basement levels : B1 & B2

Entrances & Exits are "Parking 1" and "Parking 2"

Maximum Height = 2.5 Meters

Conditions

- Free parking for the first 3 hours
- If over than that, parking fee applied at THB 30 per hour
(A Fraction Of An Hour To Be Charged For One Full Hour)
- Lost or Damage of a parking card will be fined
at THB 300
- Parking B1 & B2 operation times is 06.00-24.00 hrs.
- Parking overnight inside QSNCC are is NOT allowed.

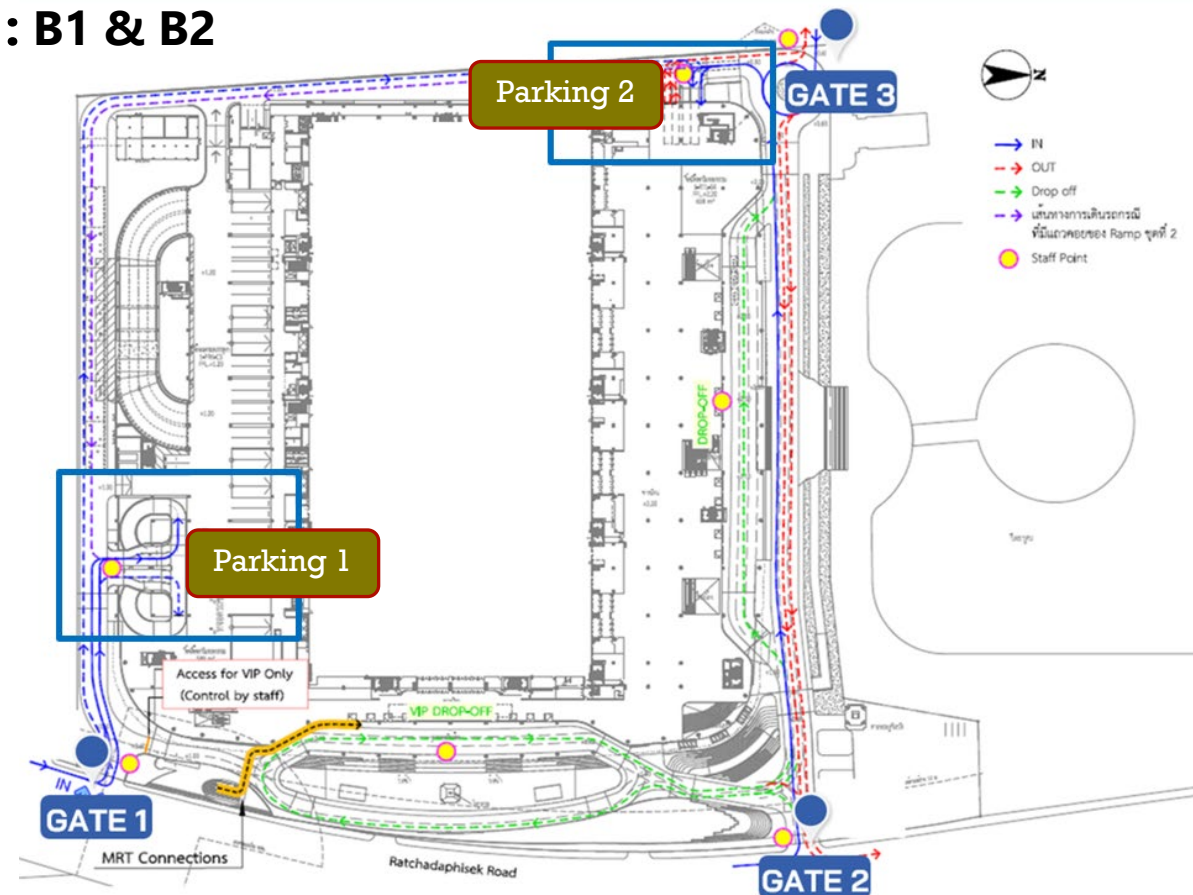

Rules & Regulations

General Rules & Regulations

- **DO NOT** smoke, drink alcohols, and stay overnight in the hall area.
- **DO NOT** bring in weapons or drugs into QSNCC.
- **DO NOT** commit illegal acts at QSNCC.
- **DO NOT** bring in animals into the venue
- **DO NOT** distribute all type of pirated goods in the venue.
- **DO NOT** use passenger elevators or escalators for loading purposes.

Rules & Regulations

Rules and Regulations for Set up and Dismantle

- **MUST** wear proper uniform & equipment as safety helmet & safety shoes
- **MUST** present authorized badge to QSNCC's security, wear a badge at all time in the venue and be around permitted working area only.
- **MUST** use only designated loading entrance. Loading goods, tools and equipment through public entrance and fire exit is prohibited
- In case of special booths, Contractors, Exhibitors and Person involved **MUST** lay plastic sheet, corrugated carpet or plywood mat for venue floor protection
- **DO NOT** bring in children or irrelevant person to the area during set up and tear down periods.

Rules & Regulations

Rules and Regulations for Set up and Dismantle

- **DO NOT** nail, drill, and apply adhesive tape at venue's floor, wall, surfaces, and structure.
- **DO NOT** pull, hold, hang, and tether anything with QSNCC building & structure.
Event Services Department reserves full right to charge for any damages if fails to comply with rules and regulations.
- **DO NOT** use any constructing tools or equipment that may cause toxic, dust, smoke, and flame.
- **DO NOT** use chemical spray or paint that causes dust and toxic.

Rules & Regulations

Rules and Regulations for Set up and Dismantle

- Using of thinner, turpentine is limited to 500 ml./booth/usage. and accompany with fire extinguisher (15 pounds of Fire Ade 2000) stand by in the working area.

Limit usage times as below :

- Inside the exhibition hall area, using of chemical substance is allowed as per setup date and time stated in the contract agreement.
- At Main Foyer, using of chemical substance is allowed only at 18.00-24.00 hrs.
- **DO NOT** bring in gas, explosives, radioactive, flammable or dangerous substance into the building.
- **DO NOT** use standard electrical sockets of the building.
- **DO NOT** adjust or modify lantern, electrical sockets, electric wire and any part of venue

Rules & Regulations

Rules and Regulations for Set up and Dismantle

- For constructing any work over 2.0 m. height, contractor must follow rules and regulations and submit catwalk permission form, scaffold permission form, and wear personal safety equipment all the time.
- **MUST** notice Event Services Department at least 3 hours in advanced for overnight working request.
All charges will be calculated by Event Services Department.
- **DO NOT** leave all materials such as wooden board, wooden crate, carton, plastic, foam, steel, etc. must be cleared out of QSNCC, otherwise operation fee will be applied.
- **DO NOT** put dangerous & toxic substance, oil, and acid into drainage ditches. Penalty fee of minimum **10,000 THB/booth** (excluded 7% VAT) will be applied at all circumstances.
- **DO NOT** leave materials and equipment in the area as per finish date & time of space rental stated in the contract agreement. Event Services Department reserves full right to clear the area by moving and storing remaining materials with the penalty fee of **10,000 THB/square meter/hour** (excluded 7% VAT).